

Assembly instructions

IN020 IN021 Expodesk

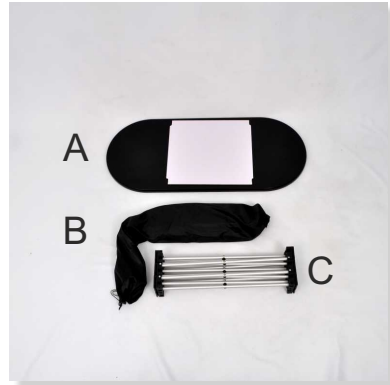

The package content:

- A. Countertop and 1 shelf.
- B. Case containing the rods: 8 straight vertical rods, 6 rods horizontal lines, 4 sticks semicircle.
- C. Stand structure.

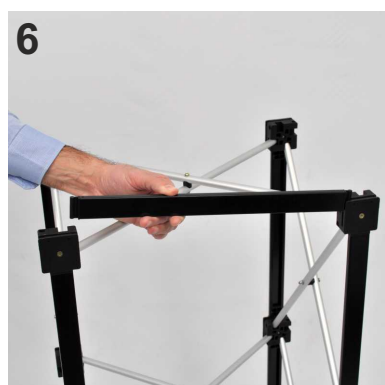
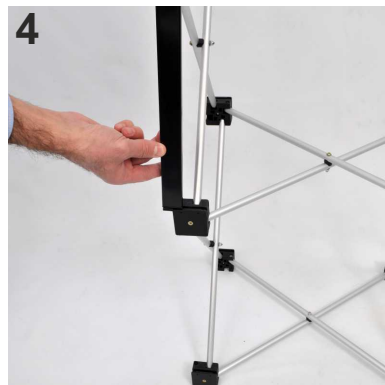
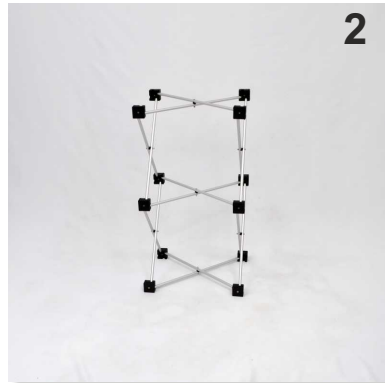
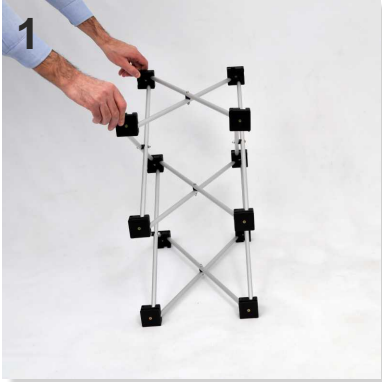

1-2 Remove the structure from the bag and place it on the floor so that the row of black squares with the groove is at the top, like in the adjacent picture. Expand the structure to size pulling up the two of the black plastic pieces, as in the adjacent picture.

3-4. Fit the eight straight rod, in a vertical position: first insert the tip of the wand into the slot in the black square above, and the part without the tip of the wand will be fixed into a vertical position, by sliding from left to right into the black square below.

5. At the end you will get four vertical lines of two rods each: two lines in the front and two lines in the back.

6. Install the six straight rods without the tip in horizontal position, as in the adjacent image.

The pictures are for presentation purposes only. Your product may be slightly different.

Assembly instructions

IN020 IN021 Expodesk



7-8. Fit the four semicircle rods on the side of the structure, top and bottom as in the picture.



9. Place the shelf in the middle of the structure, as in the picture.

10-11. Add the personalisation starting from the back to the front, continuing to the back, as in the adjacent picture.

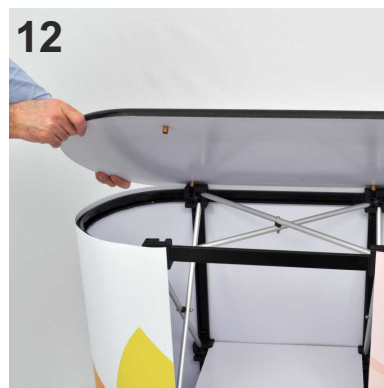

12. Place the countertop over the structure and Insert the four pegs located under the countertop into the holes in the black plastic squares. Being a flexible structure, you may need to extend the structure a little to fit all the pegs in their slot.



Now the Expodesk is assembled. To move the desk, it is advisable to grab it from the back of the structure.

The pictures are for presentation purposes only. Your product may be slightly different.